

PLAN
(LID REMOVED)

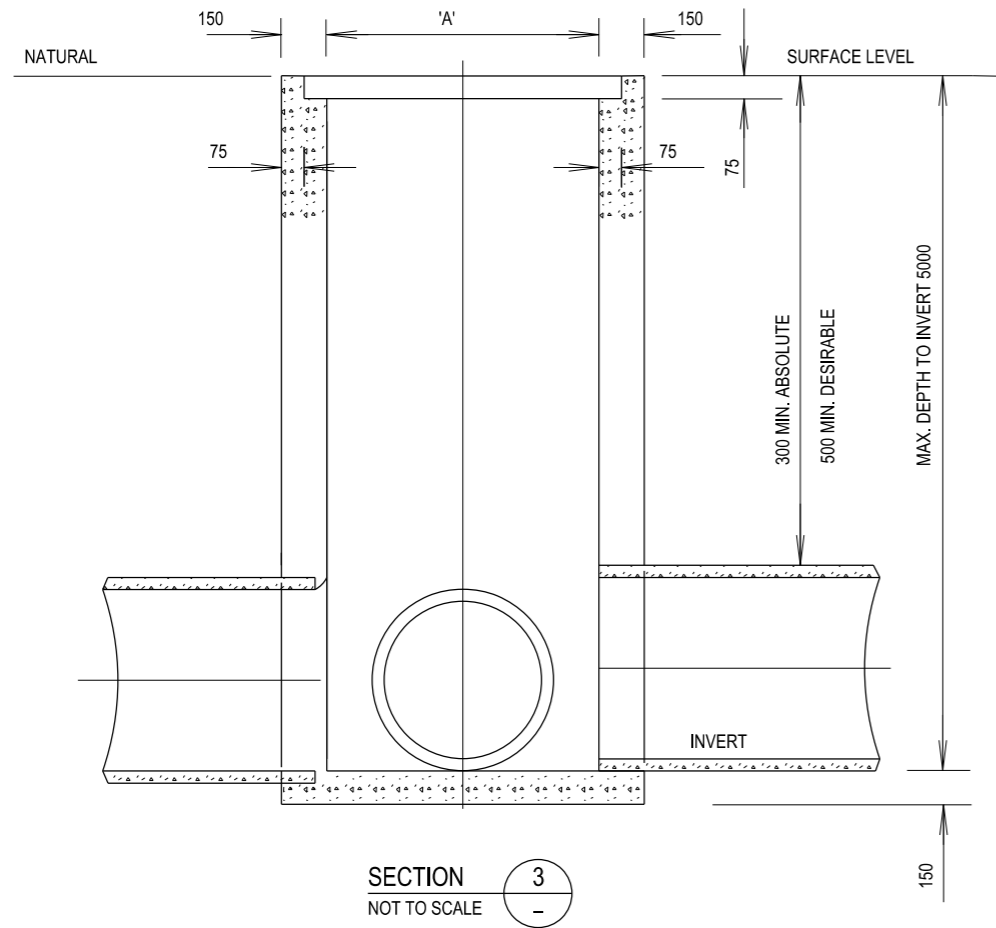

SECTION 3
NOT TO SCALE

PIT DIMENSIONS

INLET / OUTLET DIA + 200	'A'	REINF. IN WALLS/SLAB
450	735	DEPTH TO INVERT LESS THAN 1200 NO REINFORCEMENT REQUIRED. OVER 1200 PROVIDE SL82 WITH STEP IRONS.
525	810	
600	900	
750	1065	
900	1230	
1050	1395	
1200	1560	

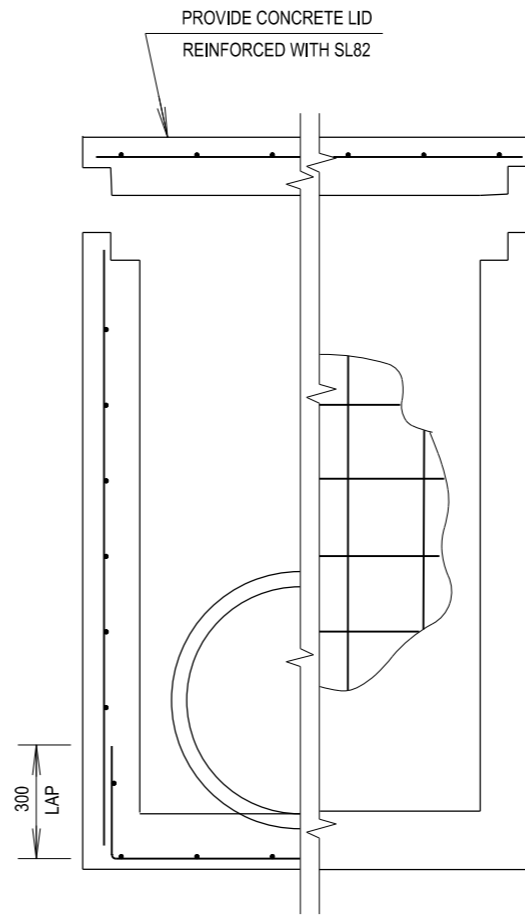

REINFORCEMENT DETAIL

NOTES

1. CONCRETE STRENGTH N25.
2. SIDE DIMENSIONS WILL VARY WITH UNEQUAL PIPE SIZES I.E. SIDE DIMENSIONS DETERMINED BY LARGEST OUTSIDE PIPE DIMENSION PLUS 200.

THIS DRAWING MAY BE PREPARED IN COLOUR AND MAY BE INCOMPLETE IF COPIED

50mm ON A3 SIZE ORIGINAL

QR CODE	SCAN TO CHECK DOCUMENT VER.	REV	DATE	AMENDMENT / REVISION DESCRIPTION	WVR No.	APPROVAL	ALL DIMENSIONS ARE IN MILLIMETRES UNLESS OTHERWISE SHOWN	CONTACT DETAILS	ISSUED	STANDARD DRAWING No.	REV.
							SCALES ON A3 SIZE DRAWING	SEND FEEDBACK ON THIS STANDARD DRAWING TO : technologystandards@rms.nsw.gov.au	SFR	R0220-39	-
							MANAGER ROAD POLICY, SPECIFICATIONS & TECHNOLOGY	DATE 20.01.17	PREPARED BY ENGINEERING SERVICES ROAD POLICY, SPECIFICATIONS AND AND TECHNOLOGY	EDMS No. DS2014/005859	ORIGINAL ISSUE DATE JANUARY 2017



STANDARD DRAWING
ROAD DESIGN ENGINEERING
R0220 STORMWATER DRAINAGE SERIES - GULLY PITS
DETAIL OF INSPECTION PIT

A3

SHEET 1 OF 1

PREPARED BY
ENGINEERING SERVICES
ROAD POLICY, SPECIFICATIONS AND
AND TECHNOLOGY

STATUS
ISSUED

© Roads and Maritime Services