

## Night Work on Alfords Point Road, Alfords Point from 4 May

### The NSW Government is funding this \$40 million project to improve safety and traffic flow on Alfords Point Road between Georges River and Brushwood Drive.

Roads and Maritime Services is continuing to construct this important project. As part of this work we will be carrying out the removal of old asphalt, installing new asphalt paving and line marking of the Brushwood Drive on ramp and the northbound lanes. This work will be carried out at night to minimise impact to motorists.

The work will take up to **10 night shifts** to complete from **Thursday 4 May** to **Monday 29 May**, weather permitting. Our working hours will be from 7pm to 5am.

We have provided a map to show the location of the work.

#### Temporary lane closures

There will be temporary lane closures between Georges River Bridge and Brushwood Drive to allow the removal of old asphalt, the installation of new asphalt paving and line marking to be carried out efficiently and ensure the safety of motorists and road workers.

The on ramp onto Alfords Point Road will be closed with a detour in place during the night work. Access through to Menai will be maintained under traffic control.

Please keep to speed limits and follow the direction of traffic controllers and signs. For the latest traffic updates, you can call 132 701, visit [livetraffic.com](http://livetraffic.com) or download the Live Traffic NSW App.

#### How will the work affect you?

There may be some construction noise and light associated with this work. We will make every effort to minimise noise by arranging the work in stages at different locations across this period. Every effort will also be made to focus light only on the working area to minimise spill-over of light into nearby residences.

#### Contact

Contact our Project Manager Ken Vo on 0407 900 287 or email [AlfordsPoint@rms.nsw.gov.au](mailto:AlfordsPoint@rms.nsw.gov.au). For more information on our projects, visit [rms.nsw.gov.au](http://rms.nsw.gov.au)

Thank you for your patience during this important work.

---

## Location of work and detour

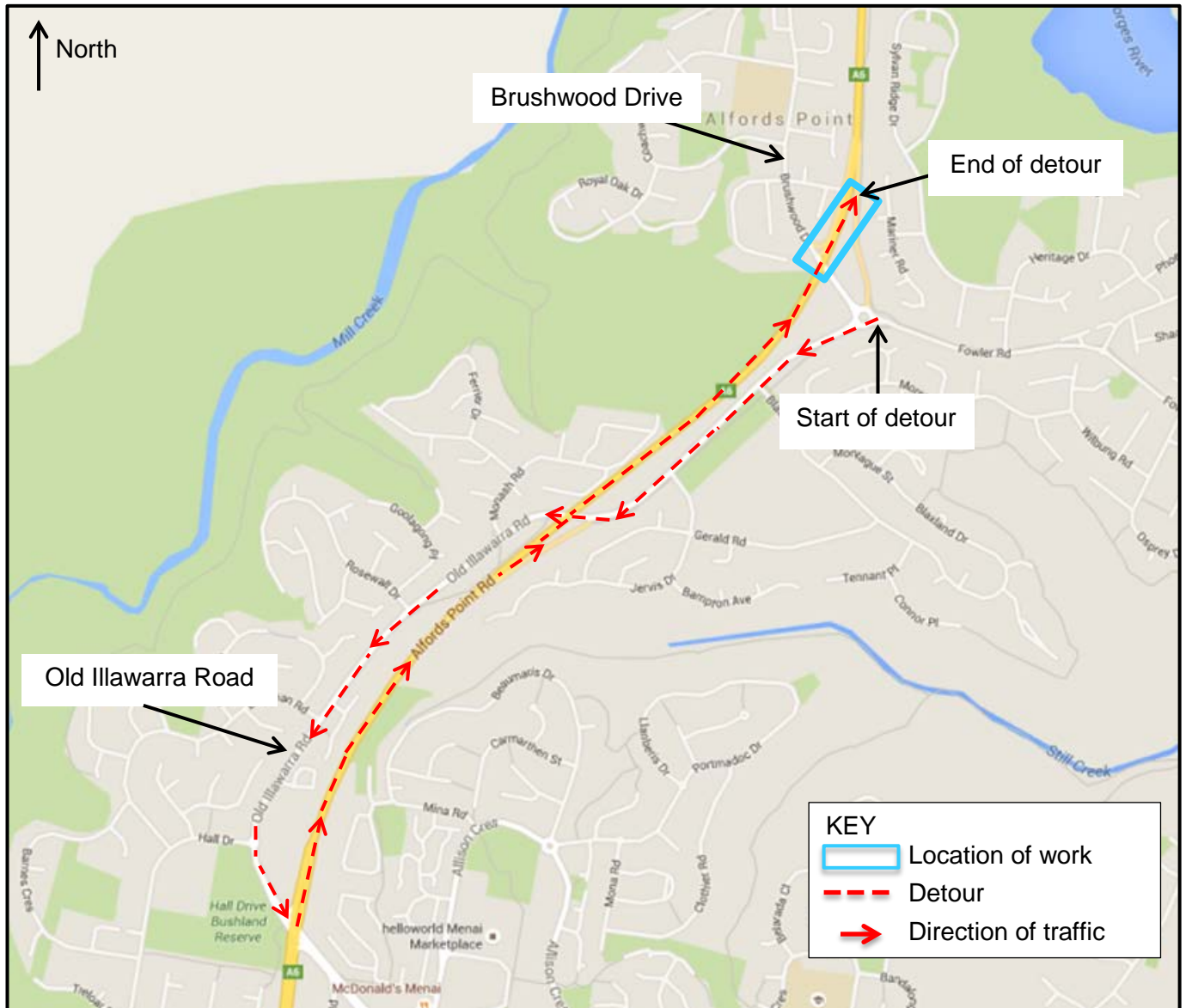

### Translating and Interpreting Service

If you need an interpreter, please call the Translating and Interpreting Service (TIS National) on **131 450** and ask them to telephone Roads and Maritime Services on 1800 035 733

#### Arabic

إذا كنتم بحاجة إلى مترجم، الرجاء الاتصال بخدمة الترجمة الخطية والشفهية (TIS National) على الرقم **131 450**، والطلب منهم الاتصال بوكاتبتكم على الرقم 1800 035 733

#### Cantonese

若你需要口譯員，請致電 **131 450** 聯絡翻譯和口譯服務署 (TIS National)，要求他們致電 1800 035 733 聯絡 Roads and Maritime Services。

#### Mandarin

如果你需要口译员，请致电 **131 450** 联系翻译和口译服务署 (TIS National)，要求他们致电 1800 035 733 联系 Roads and Maritime Services。

#### Greek

Αν χρειάζεστε διερμηνέα, παρακαλείστε να τηλεφωνήσετε στην Υπηρεσία Μετάφρασης και Διερμηνείας (Εθνική Υπηρεσία TIS) στο **131 450** και ζητήστε να τηλεφωνήσουν Roads and Maritime Services στο 1800 035 733

#### Italian

Se desiderate l'assistenza di un interprete, prego telefonare al Servizio Interpreti e Traduttori (TIS National) al **131 450** chiedendo di contattare Roads and Maritime Services al 1800 035 733

#### Korean

동역사가 필요하시면 번역동역서비스 (TIS National) 에 **131 450** 으로 연락하여 이들에게 1800 035 733 번으로 Roads and Maritime Services 에 전화하도록 요청하십시오.

#### Vietnamese

Nếu cần thông ngôn viên, xin quý vị gọi cho Dịch Vụ Thông Phiên Dịch (TIS Toàn Quốc) qua số **131 450** và nhờ họ gọi cho Roads and Maritime Services qua số 1800 035 733

