

Transport for NSW

Berry to Bomaderry Princes Highway upgrade

Project update



Australian weathering steel bridge girders in place to form an overpass of the Princes Highway between Pestells Lane and Meroo Road

Traffic movements - during construction

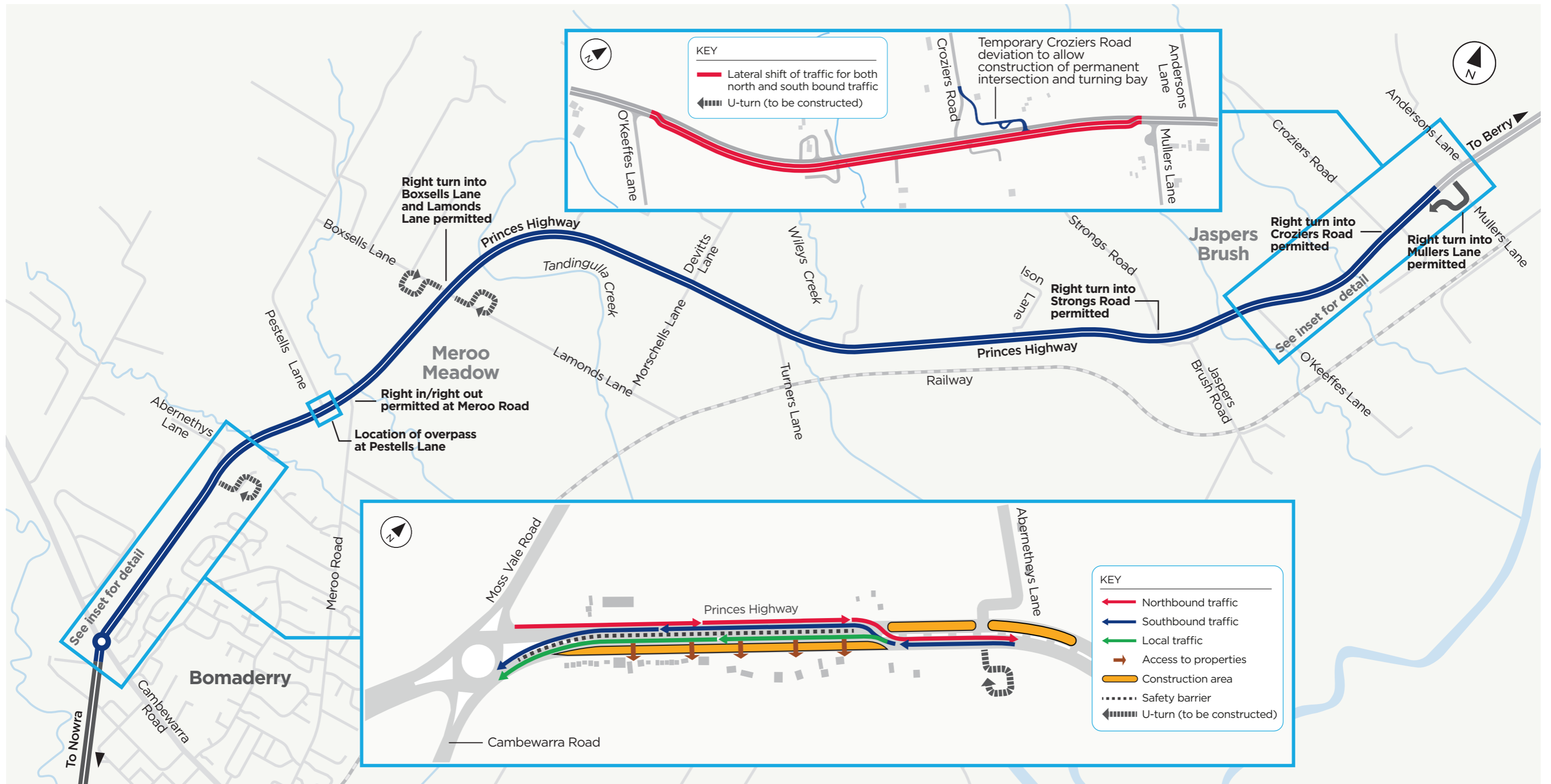

Bomaderry straight traffic switch

Traffic will be switched onto the new northbound carriageway between the Cambewarra Road roundabout at Bomaderry and Abernethys Lane, Meroo Meadow.

This temporary traffic change will allow work to begin on upgrading the old section of highway to the east.

During this work, concrete barriers will separate Princes Highway traffic from the construction area

and there will be no right-hand turns permitted across the Princes Highway from either direction.

A separate access will be in place for residents and businesses on the southbound side of the highway. This will only be accessible to southbound traffic.

All northbound motorists wishing to access businesses or property on the southbound side will need to travel to the U-turn facility opposite Abernethys Lane, Meroo Meadow to then head south.

Traffic switch between Mullers Lane and O'Keefes Lane

Traffic was switched onto a new section of highway between Mullers and O'Keefes lanes in December 2019. This traffic change includes a new, temporary access and alignment for Croziers Road.

This will allow work to begin on upgrading the old section of highway and Croziers Road intersection.



Traffic on the new carriageway between Mullers Lane and O'Keefes Lane



An Australian weathering steel bridge girder being lifted into place

Installation of Australian weathering steel bridge girders over the highway at Meroo Meadow

Two key features of the Berry to Bomaderry upgrade will be Australian weathering steel bridges at Strongs Road, Jaspers Brush and at Pestells Lane, Meroo Meadow.

Weathering steel is strong and highly resistant to corrosion due to the protective rust layer (also known as a patina) which forms on the surface and protects it from the elements. This type of steel is expected to last more than 100 years and requires very little maintenance.

The first three of these weathering steel girders are now in place and will connect Pestells Lane and Meroo Road. Each girder measures around 100 metres long and weighs around 109 tonnes.

Installation of the girders occurred over a number of nights in December 2019 and required the full closure of the Princes Highway on the night of 9 December. We thank the community for their patience during this closure while we completed this important work.

Contact us:

If you have any questions or would like more information on the Berry to Bomaderry upgrade please contact our project team:

☎ 1800 506 976

@ BerrytoBomaderryUpgrade@DSWJV.com.au

🖥 rms.nsw.gov.au/bbu

✉ PO Box 309 Berry NSW 2535

Have
your
say



480,000m³
of earth moved



Lateral traffic shifts
during construction



Use U-turn facilities
to access properties



29,000m²
of paving laid



3.5km of 15km of
drainage complete



Each girder around
100 metres long and
weighs 109 tonnes



This document contains important information about public transport projects in your area. If you require the services of an interpreter, please contact the Translating and Interpreting Service on 131 450 and ask them to call Transport Projects on 1800 506 976. The interpreter will then assist you with translation.