

Traffic delays – New England Highway, Bolivia Hill from Monday 3 December 2018

Major work is starting on the Bolivia Hill upgrade which will make the New England Highway safer and easier to drive.

Work to significantly improve the New England Highway at Bolivia Hill is stepping up. Work is starting on preparing the highway for major excavation of the adjoining rock face. This work is in preparation for major work starting early next year to widen sections of the highway, and commence work on the foundations of a new 320 metre long bridge.

From **Monday 3 December 2018**, work will start to stabilise the eastern slope of the highway in preparation for a major excavation of the slope in the New Year. To stabilise the slope a number of boulders have to be removed. For the safety of motorists traffic will be stopped during their removal.

Traffic impacts

- The highway will be reduced to one lane between 6am and 6pm Monday to Saturday for 12 weeks
- The highway will be fully closed three times per day for 30 minutes between 9 – 10am, 12 – 1pm and 3 – 4pm, Monday to Saturdays for the first two weeks of the work.

Dates	Traffic changes
Monday 3 December to Saturday 15 December	<ul style="list-style-type: none"> • Reduced to one lane between 6am and 6pm. • 30 minute full closure between 9 – 10am, 12 – 1pm and 3 – 4pm each day Monday to Saturdays. Delays of 40 minutes expected and 10 minutes at all other times between 6am and 6pm • The highway will be fully open to traffic each night.
Monday 17 December to Friday 21 December	<ul style="list-style-type: none"> • Reduced to one lane between 6am to 6pm 10 – 15 minute delays expected. Fully open overnight

Why do we need to do this work?

To straighten this section of the highway major excavation of the slope adjoining the highway is needed. Before excavating, the slope must be stabilised so any vibration during excavation does not cause a rock fall.

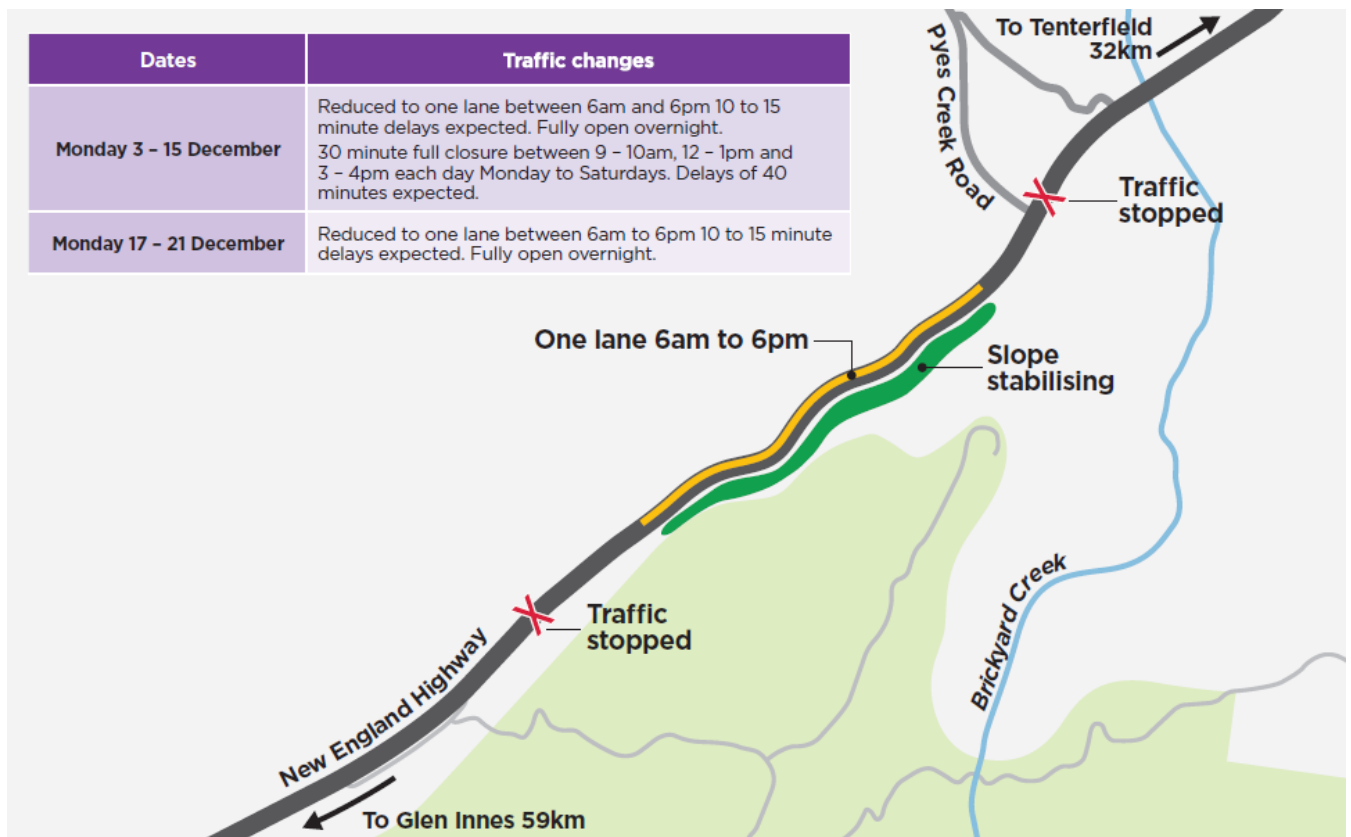

For more information

If you have any questions please contact the Bolivia Hill upgrade project toll free line on 1800 958 057, boliviahill.community@georgiou.com.au or visit the project website www.rms.nsw.gov.au/boliviahill

For the latest traffic updates during this work call 132 701, visit livetraffic.com or download the Live Traffic NSW App.

We apologise for any inconvenience and thank you for your patience during this important work.



If you need help understanding this information, please contact the Translating and Interpreting Service on 131 450 and ask them to call us on 1800 958 057