



Work to improve the roundabout at the intersection of Villiers and Pound streets

When the new Grafton bridge is complete, the intersection of Villiers and Pound streets will become part of the new Summerland Way.

Work to improve the intersection is underway and will be carried out over the coming months. The work will extend the life of the existing roundabout and reduce the need for ongoing maintenance.

The work involves firstly removing the vegetation in the middle of the roundabout and building temporary road pavement. Sections of the existing concrete roundabout will then be removed and replaced, the road pavement widened and new kerb and finishing work carried out.

This work will be carried out in two stages, starting on the eastern side of the roundabout. We have included a map showing the staging of the work and traffic changes.

Traffic changes

To allow us to carry out this work safely and efficiently, a number of traffic changes will be implemented:

- The intersection will become one lane in either direction to maintain the priority for the large volume of traffic on Villiers Street.
- During stages one and two a left-in from Villiers Street will be maintained for all vehicles for the section of Pound Street between Villiers and Duke streets.
- During stage one the section of Pound Street between Clarence and Villiers streets will temporarily become a cul-de-sac. The current u-turn near the roundabout will remain in place.
- During both stages the left turn out of Pound Street into Villiers Street will not be permitted (for the section of Pound Street between Duke and Villiers streets). Signposted detours will be in place.

We have been working with businesses, TAFE and Grafton Shoppingworld about this work. We will notify you prior to work being carried out on the northern half of the roundabout.

How will the work affect you?

The work will involve the use of machinery which will generate noise. The work involves the use of light vehicles, lighting towers, chainsaws, trucks, a crane, a road saw, a profiler and asphaltting equipment. The current approved construction hours for the project are:

- Monday to Friday 7am to 6pm
- Saturdays 8am to 1pm

Saw-cutting may also be required outside of standard working hours. If so, we will contact nearby residents in advance.

Some dust and vibration also will be generated.

We will reduce these impacts by:

- carrying out high-noise activities earlier in the night where possible
- using dust mitigation measures such as water carts
- directing light towers downwards and away from residences to reduce light spill
- offering alternative accommodation to impacted residents
- planning activities to minimise noise from reversing vehicles
- minimising the height at which materials are dropped when loading into trucks.

Contact us

If you have any questions or concerns about this work, or to register your general feedback, please contact the community relations team via:

Phone: 1800 918 759

Email: graftonbridgecommunity@fultonhogan.com.au

Mail: PO Box 546 Grafton, NSW 2460

In person: visit the Community Display Centre at the corner of Duke and Pound streets, Grafton.

For more information on this project, visit www.rms.nsw.gov.au/graftonbridge.

Temporary traffic changes during Stage 1 of work

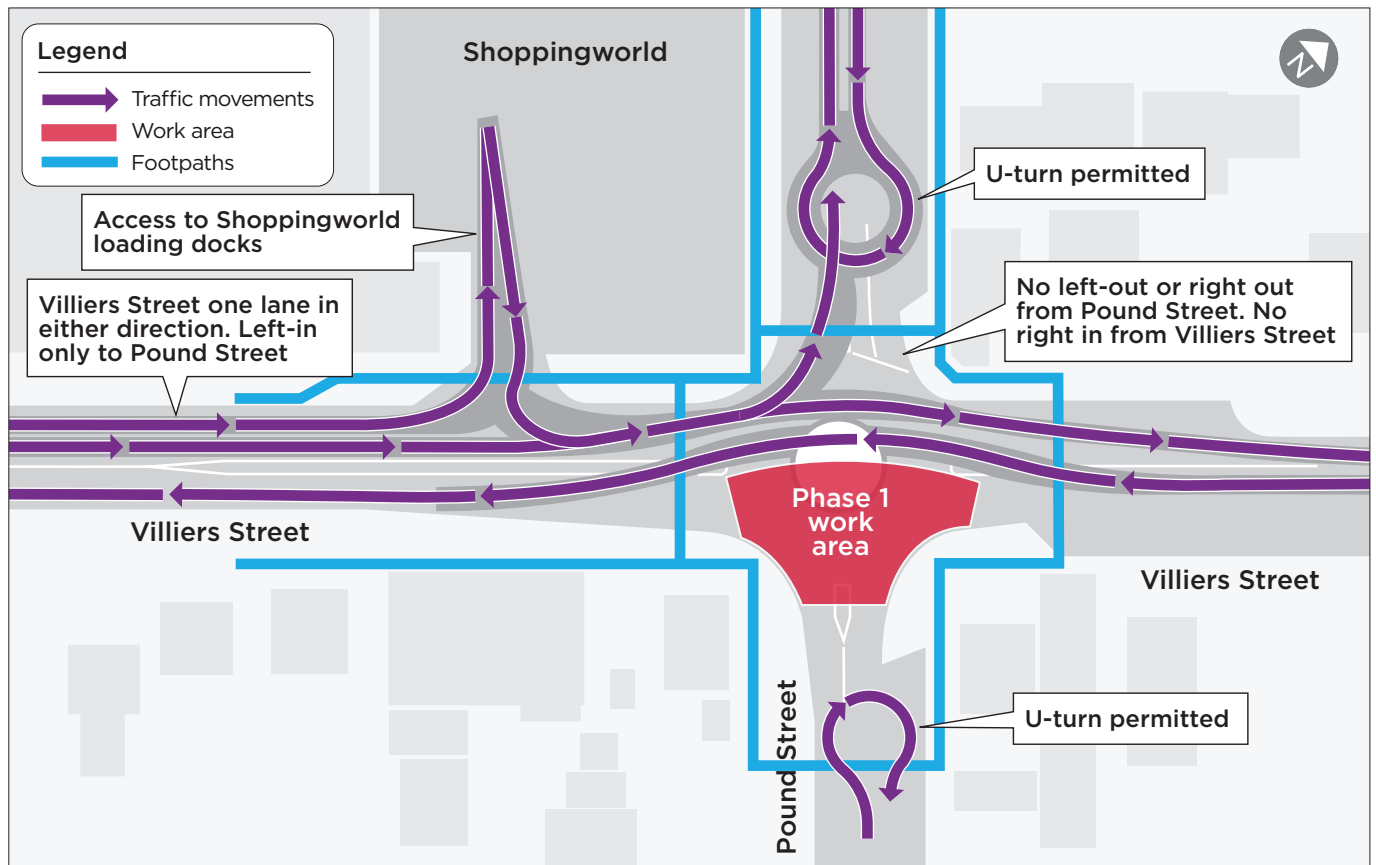

Temporary traffic changes during Stage 2 of work

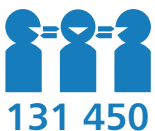
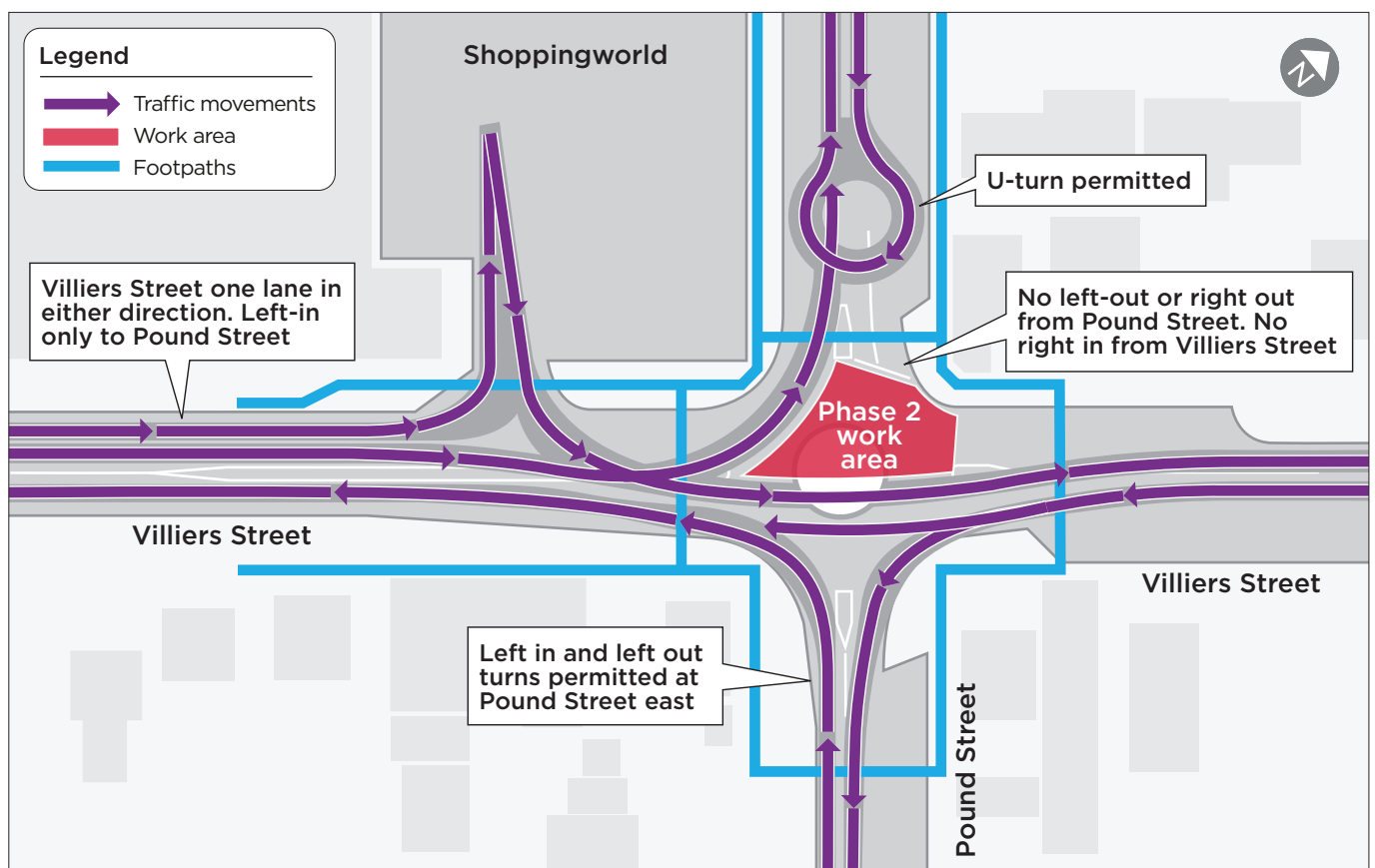

If you need help understanding this information, please contact the Translating and Interpreting Service on **131 450** and ask them to call us on **1800 918 759**