



Australian Government

BUILDING OUR FUTURE



April 2018

Night work continuing on The Northern Road, South Penrith from Saturday 5 May 2018

The Australian and NSW governments are jointly funding this work as part of the \$1.6 billion upgrade of The Northern Road between Narellan and South Penrith.

Roads and Maritime Services is widening The Northern Road between Glenmore Parkway, Glenmore Park and Jamison Road, South Penrith and building a new interchange over the M4 Motorway at South Penrith.

As part of this work, on The Northern Road we will continue installing and adjusting barriers and signage, line marking, clearing vegetation, utility investigation and relocation work, potholing, asphaltting and building temporary lanes, building retaining walls, road demolition and building new drainage.

On the M4 Motorway, night work will continue including building bridge structures, utility investigations, line marking, clearing vegetation, building temporary access roads and concrete platforms, earthworks, building retaining walls, transporting equipment, installing and adjusting barriers and signage.

We have included a map to show the location of this work.

Our work schedule

Work will be carried out at night between **7pm** and **7am** from **Saturday 5 May 2018 to Thursday 5 July 2018**, weather permitting. We are carrying our work at night when traffic volumes are lower to minimise traffic impact and improve safety for workers and motorists.

Early morning and late evening concrete pours may be needed as high temperatures can affect the quality of concrete. A few hours preparation may be needed before pouring but we will advise you before this work starts. Work may be carried out between 8am to 6pm on Saturdays and 10am to 6pm on Sundays. We will advise affected residents before this work starts.

How will the work affect you?

Pedestrian access will change along The Northern Road. Temporary footpaths will be built between Bringelly Road and Jamison Road. Pedestrian access will be restricted between Frogmore Road and Bringelly Road.

Every effort will be made to minimise the impact on residents and businesses by:

- changing our construction methods to reduce night work impact - scheduling noisier activities in the earliest part of the shift, where possible
- alternating between work locations to minimise continuous impacts on the same community
- using equipment fitted with noise mitigation devices and monitoring noise at night.

Traffic changes

At the intersection of Parker Street and Jamison Road, the existing traffic lights will be replaced with temporary traffic lights.

For the safety of motorists and workers, there will be some traffic changes and temporary lane closures. These closures may affect travel times. Please keep to speed limits and follow the direction of signs and traffic controllers.

For the latest traffic updates, you can call 132 701, visit [livetraffic.com](https://www.livetraffic.com) or download the Live Traffic NSW App.

Contact

If you have any questions or complaints, please contact our delivery partner Lendlease on 1800 870 665 or TNR.community@lendlease.com. For more information on our projects, visit rms.nsw.gov.au/thenorthernroad.

Thank you for your patience during this important work.

Map of night work locations and changes to pedestrian access

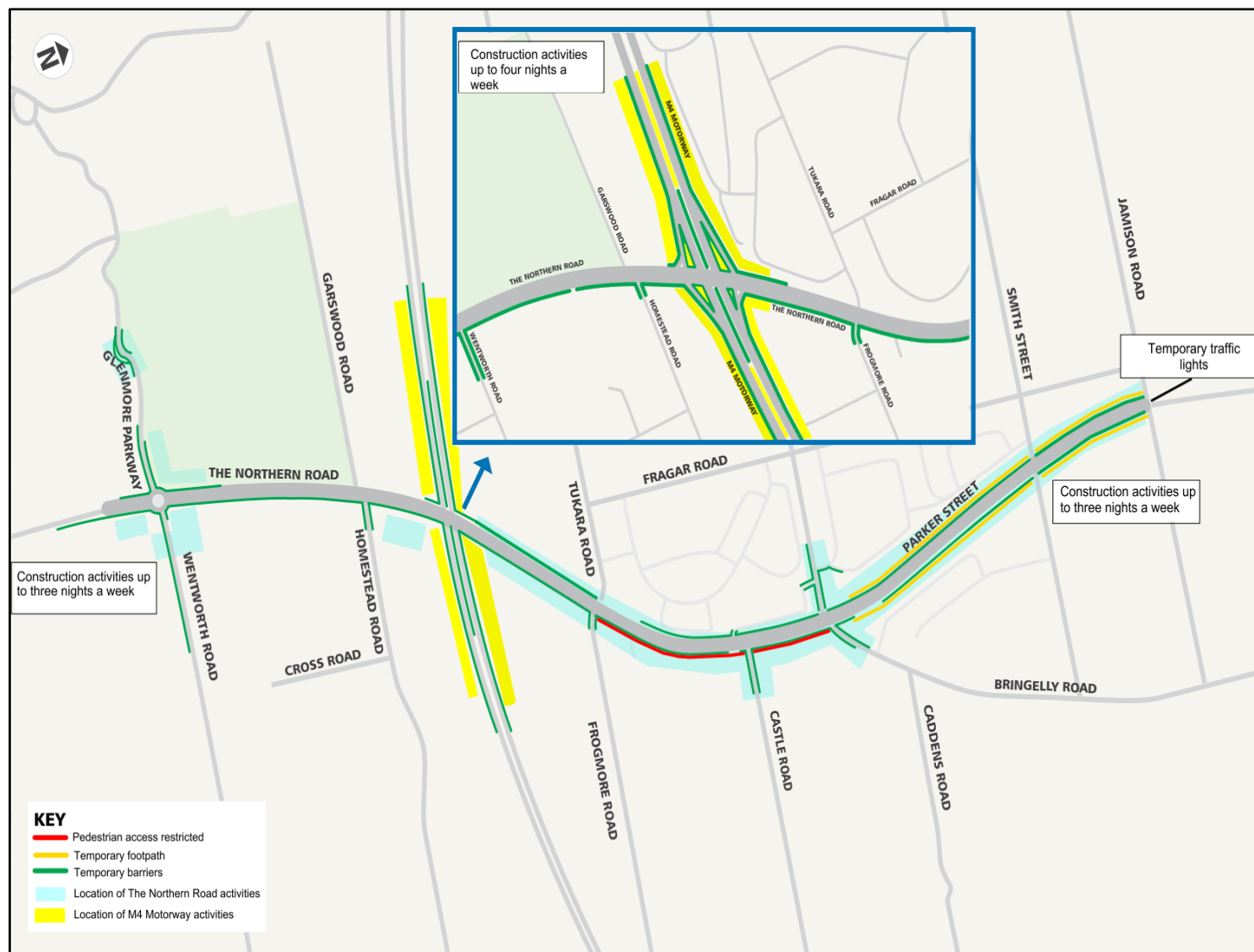

Translating and Interpreting Service

If you need an interpreter, please call the Translating and Interpreting Service (TIS National) on 131 450 and ask them to telephone Lendlease on 1800 870 665

