

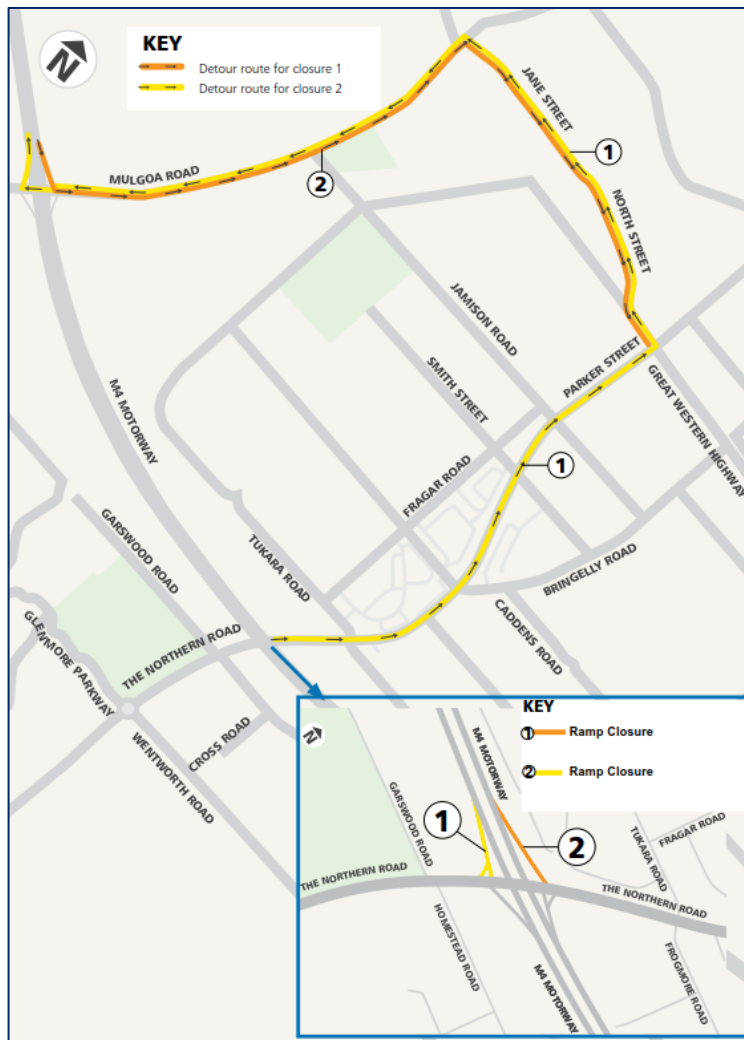

June 2019
Notification: N005

Further night work and M4 Motorway ramp closures on The Northern Road, South Penrith

Roads and Maritime Services is continuing work over the M4 Motorway at The Northern Road, South Penrith as part of The Northern Road upgrade between Glenmore Parkway, Glenmore Park and Jamison Road, South Penrith.



Out of hours work

We are continuing to carry out work on the M4 Motorway ramps as part of the upgrade to the M4 Interchange bridge.

We will carry out some of this work at night to minimise the impact on traffic and improve safety for workers and motorists.

This work will take place at night at the following locations and times:

West-facing M4 Motorway ramp closure

The west-facing M4 Motorway ramps at The Northern Road will be closed overnight, weather permitting on:

- **Friday 14 June from 9pm to 8am**
- **Saturday 15 June from 9pm to 9am**

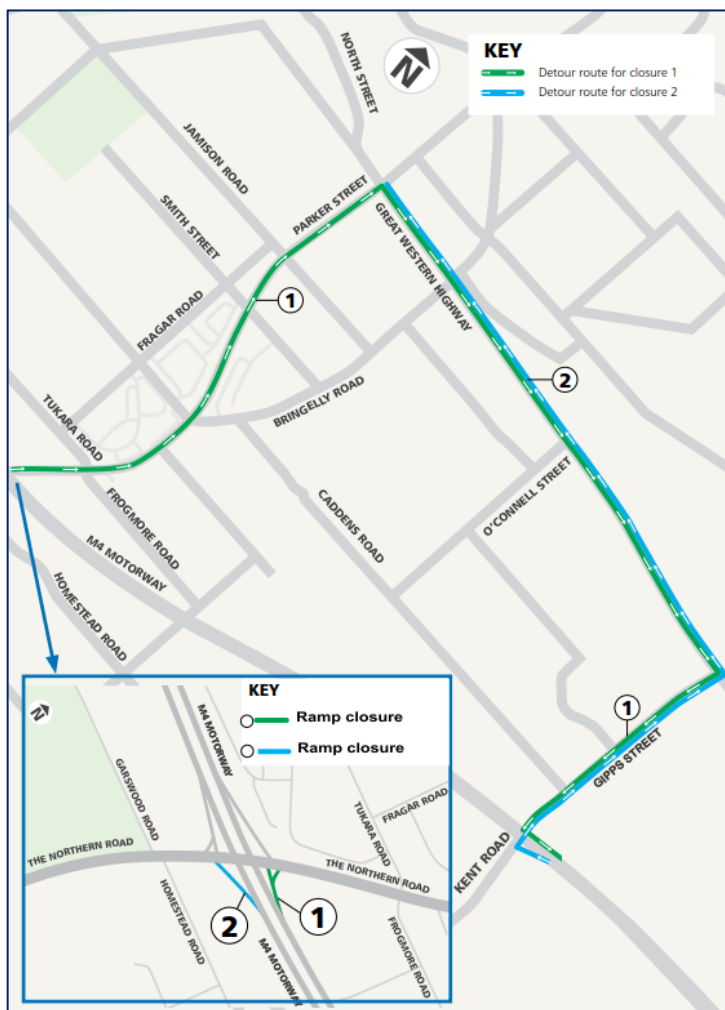

East-facing M4 Motorway ramp closure

The east-facing M4 Motorway ramps at The Northern Road will be closed overnight, weather permitting, on:

- **Friday 21 June from 9pm to 8am**
- **Saturday 22 June from 9pm to 9am**

The west-facing and east-facing M4 Motorway ramps may be closed overnight as contingency, weather permitting, on:

- **Sunday 16 June from 9pm to 5am**
- **Sunday 23 June from 9pm to 5am**
- **Friday 28 June from 9pm to 8am**
- **Saturday 29 June from 9pm to 9am**

Traffic changes

Detours will be in place during the ramp closures which may affect travel times, please see maps for more information.

Please keep to speed limits and follow the direction of detour signs and traffic

How will the work affect you?

Our work will include:

- earthwork
- constructing drainage and road pavement
- asphaltting
- relocating street lights
- adjusting temporary barriers and signage
- line marking.

Our work may be noisy at times and will involve cranes, saw cutting, loading and unloading trucks and hand tools. Every effort will be made to minimise impact on residents by:

- adapting our construction methods to reduce night work impacts as much as possible
- using equipment fitted with noise mitigation devices
- monitoring noise at night.

Contact

For the latest traffic updates, you can call 132 701, visit livetraffic.com or download the Live Traffic NSW App.

If you have any questions or complaints, please contact our delivery partner Lendlease on 1800 870 665 or TNR.community@lendlease.com. For more information, visit rms.nsw.gov.au/thenorthernroad.

Thank you for your patience during this important work.



If you need help understanding this information, please contact the Translating and Interpreting Service on 131 450 and ask them to call us on 1800 870 665