



Australian Government

BUILDING OUR FUTURE



October 2017

Night work and ramp closures on the M4 Motorway at The Northern Road, South Penrith from Friday, 13 October 2017

Roads and Maritime Services is continuing work to build a new bridge over the M4 Motorway at The Northern Road, South Penrith.

Work includes installing temporary barriers, building temporary access roads and concrete platforms, earthwork, building retaining walls, transporting equipment, clearing vegetation, installing or changing signs and line marking.

As part of this work, the M4 entry and exit ramps at The Northern Road will be closed at night between **10pm** and **8am** on the following dates:

Closure dates	M4 Motorway Interchange ramps	Map detour reference
Friday 13 and Saturday 14 October 2017	<ul style="list-style-type: none"> Eastbound on-ramp to the M4 Motorway Westbound off-ramp to The Northern Road 	<ul style="list-style-type: none"> Detour 1 Detour 2
Friday 27 and Saturday 28 October 2017		
Friday 20 and Saturday 21 October 2017	<ul style="list-style-type: none"> Eastbound off-ramp to The Northern Road Westbound on-ramp to the M4 Motorway 	<ul style="list-style-type: none"> Detour 3 Detour 4
Friday 3 and Saturday 4 November 2017		

How will the work affect you?

Our work may be noisy at times but every effort will be made to minimise impact on residents.

This work will be carried out at night when traffic volumes are lower to minimise impact on traffic and safety of workers and motorists.

Traffic changes

Detours and lane closures will be in place during ramp closures, and these may affect travel times.

We have included a map to show the location of work and detour routes.

Please keep to speed limits and follow the direction of detour signs and traffic controllers. For the latest traffic updates, you can call 132 701, visit livetraffic.com or download the Live Traffic NSW App.

Contact

If you have any questions or complaints, please contact our delivery partner Lendlease on 1800 870 665 or TNR.community@lendlease.com. For more information on our projects, visit rms.nsw.gov.au/thenorthernroad.

Thank you for your patience during this important work.

The Northern Road and M4 Motorway detour maps and M4 Motorway work locations

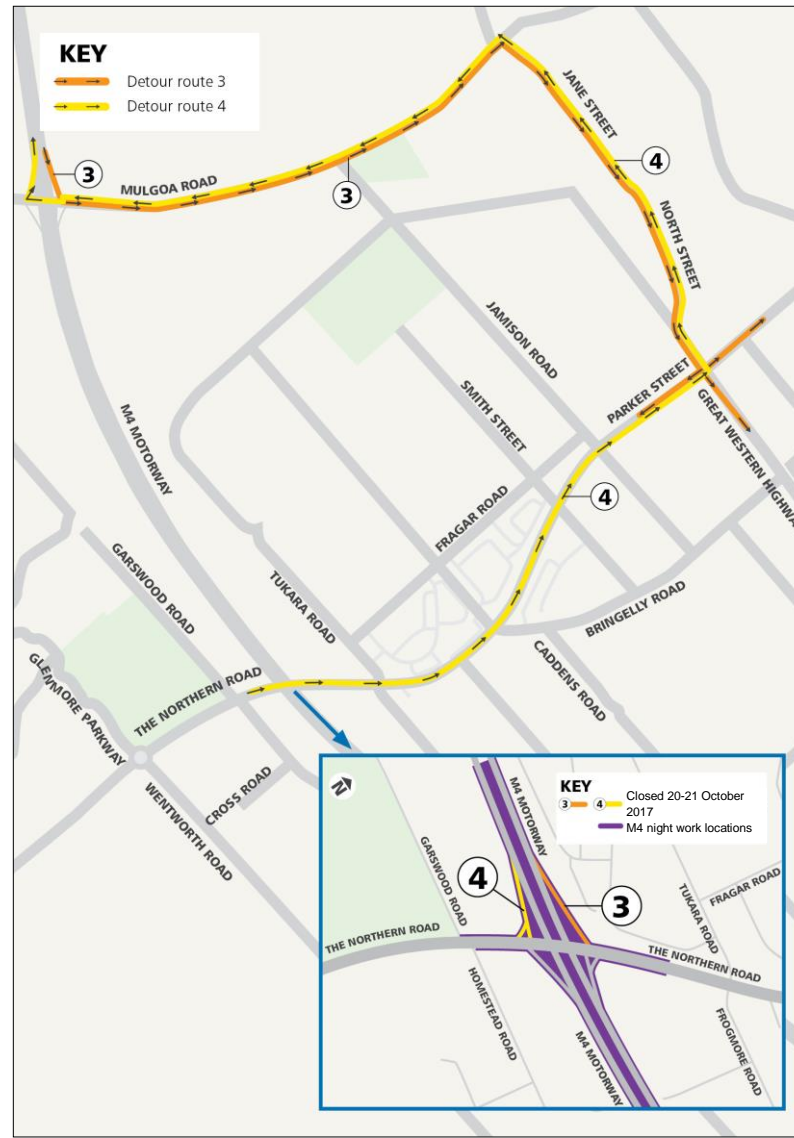
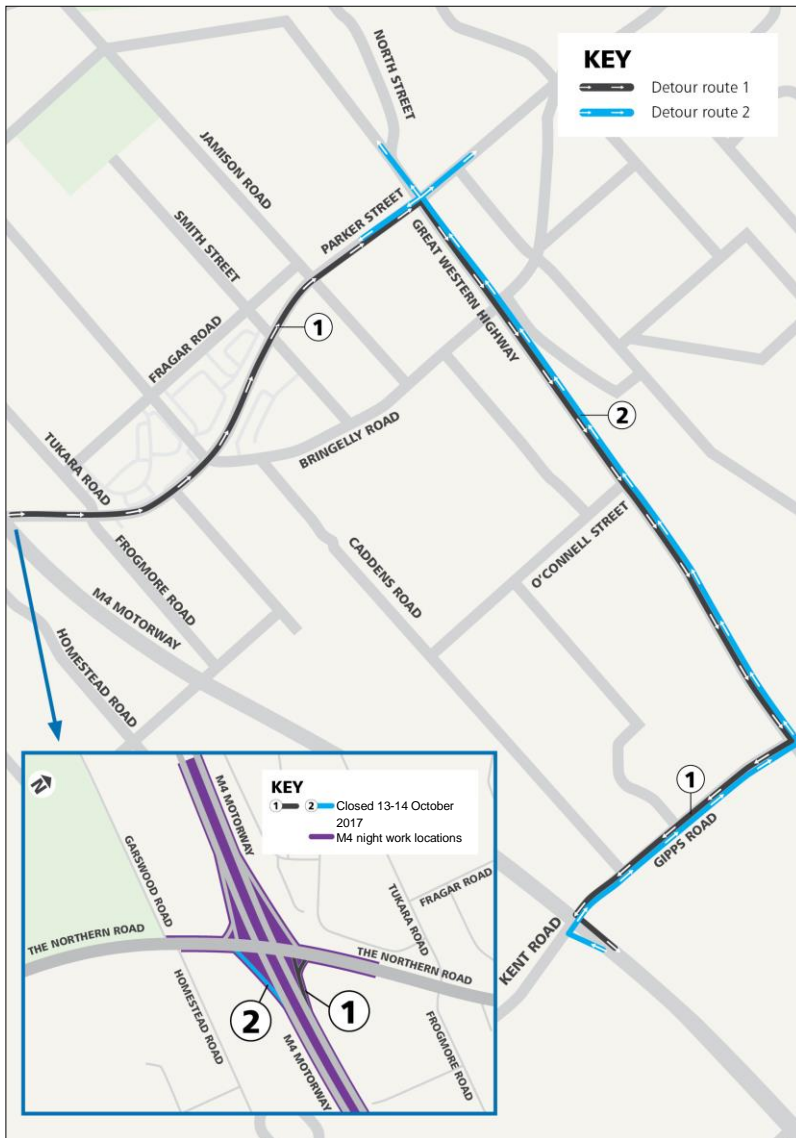

Translating and Interpreting Service

If you need an interpreter, please call the Translating and Interpreting Service (TIS National) on 131 450 and ask them to telephone Lendlease on 1800 870 665

