



Australian Government

BUILDING OUR FUTURE



September 2017

Night work, ramp closures and speed limit changes on the M4 Motorway at The Northern Road, South Penrith from Friday, 8 September 2017

Roads and Maritime Services is starting work to build a new bridge over the M4 Motorway at the Northern Road, South Penrith.

Work includes installing temporary barriers, building temporary access roads, concrete platforms, retaining walls, earthworks, transporting equipment, clearing vegetation, installing signs and line marking.

Work will be carried out at night between **7pm** and **8am** from **Friday, 8 September** to **Sunday, 3 December 2017**, weather permitting.

As part of this work, the M4 entry and exit ramps at The Northern Road will be closed between **10pm** and **8am** on the following dates:

Ramp closure dates	M4 Motorway ramp affected	Map reference
Friday 8 and Saturday 9 September 2017	<ul style="list-style-type: none"> Eastbound on-ramp to the M4 Motorway Westbound off-ramp to The Northern Road 	<ul style="list-style-type: none"> Detour 1 Detour 2
Friday 15 and Saturday 16 September 2017	<ul style="list-style-type: none"> Eastbound off-ramp to The Northern Road Westbound on-ramp to the M4 Motorway 	<ul style="list-style-type: none"> Detour 3 Detour 4
Friday 29 and Saturday 30 September 2017	<ul style="list-style-type: none"> Eastbound on-ramp to the M4 Motorway Westbound off-ramp to The Northern Road 	<ul style="list-style-type: none"> Detour 1 Detour 2

How will the work affect you?

Our work may be noisy at times but every effort will be made to minimise impact on residents.

Some of this work will be carried out at night when traffic volumes are lower to minimise impact on traffic and safety of workers and motorists.

Traffic changes

Temporary traffic changes including lane closures will be in place to ensure the work zones are safe. Work will be carried out up to **five nights** a week with no more than three consecutive nights at any one location, unless agreed with impacted residents.

Detours during ramp closures will be in place and these may affect travel times. We have included a map to show the location of work and detour routes.

To ensure the safety of workers and motorists, the speed limit on the M4 Motorway between Kent Road, Claremont Meadows and Mulgoa Road, Jamisontown will be **reduced to 80km/h, 24 hours a day seven days a week from Friday, 8 September 2017**. This reduced speed limit will be in place until project completion in 2020.

Please keep to speed limits and follow the direction of detour signs and traffic controllers. For the latest traffic updates, you can call 132 701, visit livetraffic.com or download the Live Traffic NSW App.

Contact

If you have any questions or complaints, please contact our delivery partner Lendlease on 1800 870 665 or TNR.community@lendlease.com. For more information on our projects, visit rms.nsw.gov.au/thenorthernroad. Thank you for your patience during this important work.

The Northern Road and M4 Motorway detour maps and M4 Motorway work locations

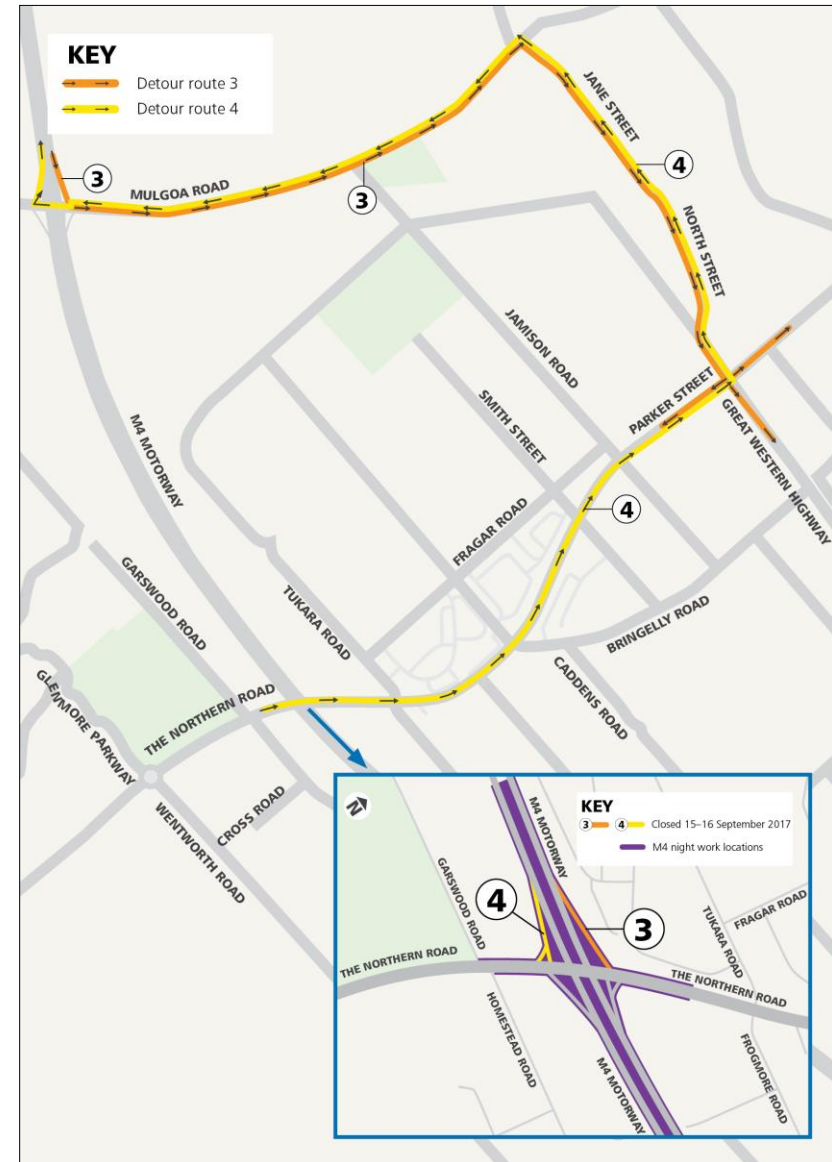
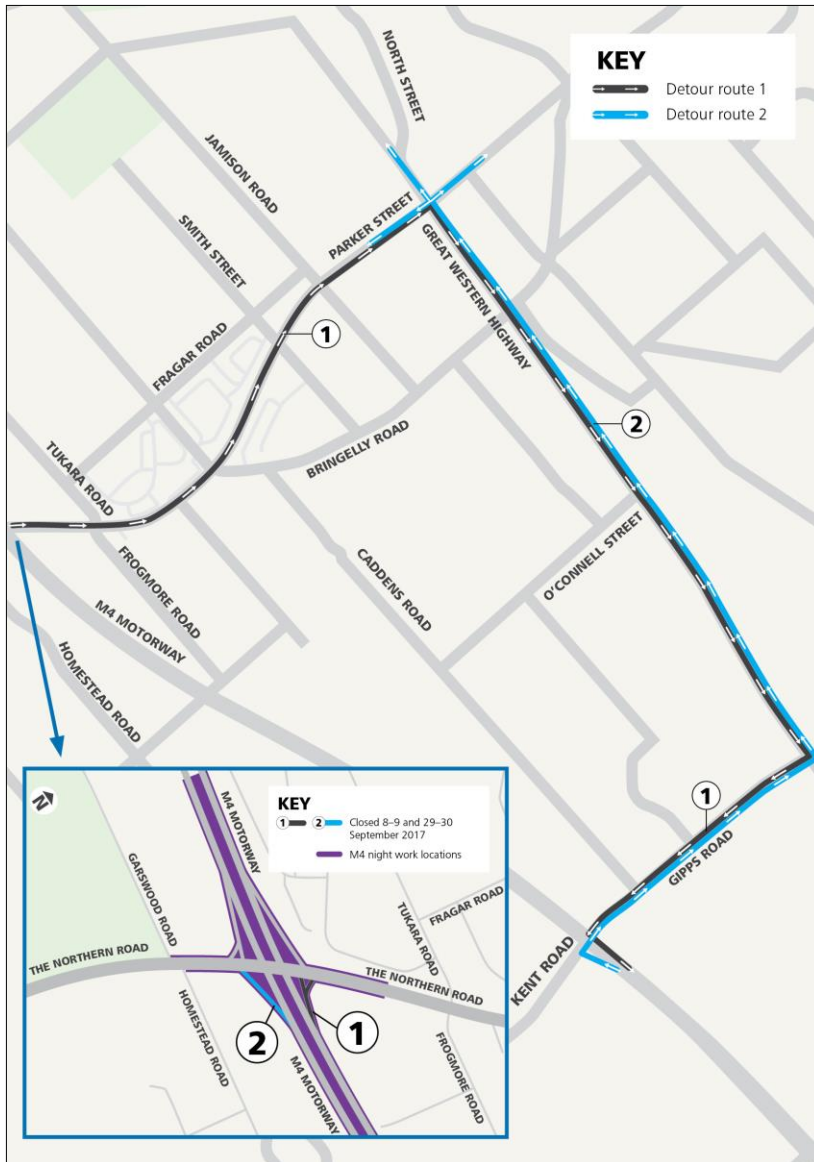

Translating and Interpreting Service

If you need an interpreter, please call the Translating and Interpreting Service (TIS National) on 131 450 and ask them to telephone Lendlease on 1800 870 665.

