

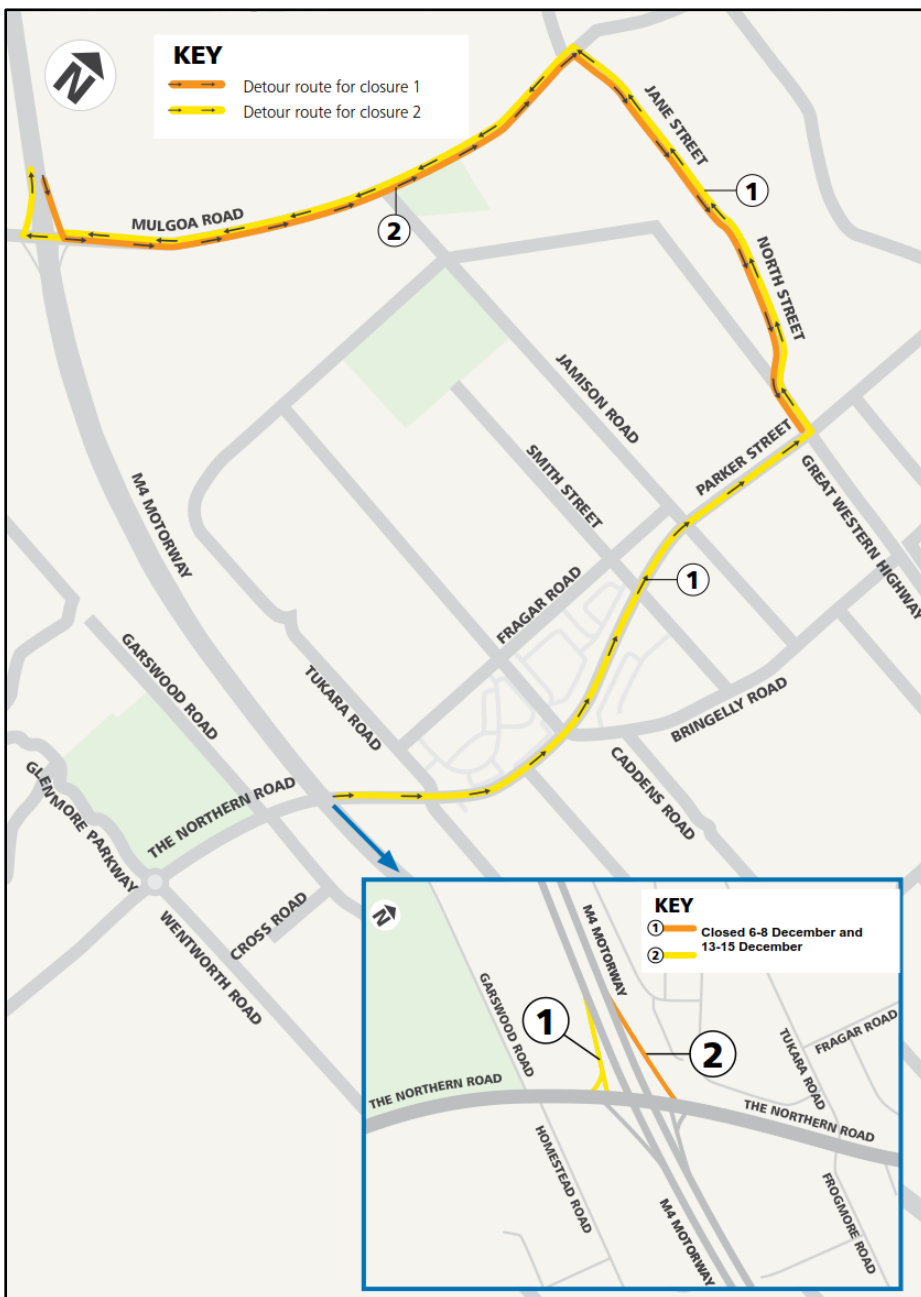

Night work and ramp closures on the M4 Motorway at The Northern Road, South Penrith from Thursday 6 December 2018

The Australian and NSW Governments are delivering the \$1.6 billion upgrade of The Northern Road between Narellan and South Penrith.

The Northern Road and M4 Motorway detour map and work location



Roads and Maritime Services is continuing work to build a new bridge over the M4 Motorway at The Northern Road, South Penrith. To minimise the impact on road users, some of this work will take place at night.

The eastbound off ramp and westbound on ramp at the M4 Motorway interchange at The Northern Road will be closed from 10pm each night on the following dates, weather permitting:

- **Thursday 6 December, reopening at 5am**
- **Friday 7 December , reopening at 8am**
- **Saturday 8 December, reopening at 9am**
- **Thursday 13 December, reopening at 5am**
- **Friday 14 December, reopening at 8am**
- **Saturday 15 December, reopening 9am.**

Work includes installing temporary barriers, building temporary access roads, changing signage and line marking.

How will the work affect you?

Our work may be noisy at times and will involve cranes, saw cutting, loading and unloading trucks and hand tools. Every effort will be made to minimise impact on residents by:

- Adapting our construction methods to reduce night work impacts as much as possible
- Using equipment fitted with noise mitigation devices
- Monitoring noise at night.

Traffic changes

Detours will be in place during the M4 eastbound off ramp and westbound on ramp closures. This may affect travel times. We have included a map to show the location of work and detour route.

Please keep to speed limits and follow the direction of detour signs and traffic controllers. For the latest traffic updates, you can call 132 701, visit livetraffic.com or download the Live Traffic NSW App.

Contact

The Australian and NSW Governments are jointly funding this work as part of the \$1.6 billion upgrade of The Northern Road between Narellan and South Penrith. If you have any questions or complaints, please contact our delivery partner Lendlease on 1800 870 665 or TNR.community@lendlease.com. For more information on our projects, visit rms.nsw.gov.au/thenorthernroad.

Thank you for your patience during this important work.



If you need help understanding this information, please contact the Translating and Interpreting Service on 131 450 and ask them to call us on 1800 870 665