



Night work and M4 Motorway ramp closures

The Northern Road, South Penrith from Saturday 23 March

Roads and Maritime Services is continuing work to complete the new bridge over the M4 Motorway at The Northern Road, South Penrith as part of The Northern Road upgrade between Glenmore Parkway and Jamison Road. We're close to finishing the work on the new bridge and we will provide further information about opening the new bridge and traffic arrangements closer to the opening date.

Out of hours work

Further work is required on the M4 Motorway ramps before we open the new bridge to traffic. This work will take place at night at the following locations and times. Some of this work will take place at night to minimise the impact on traffic and improve safety for workers and motorists.

East-facing M4 Motorway ramp closure

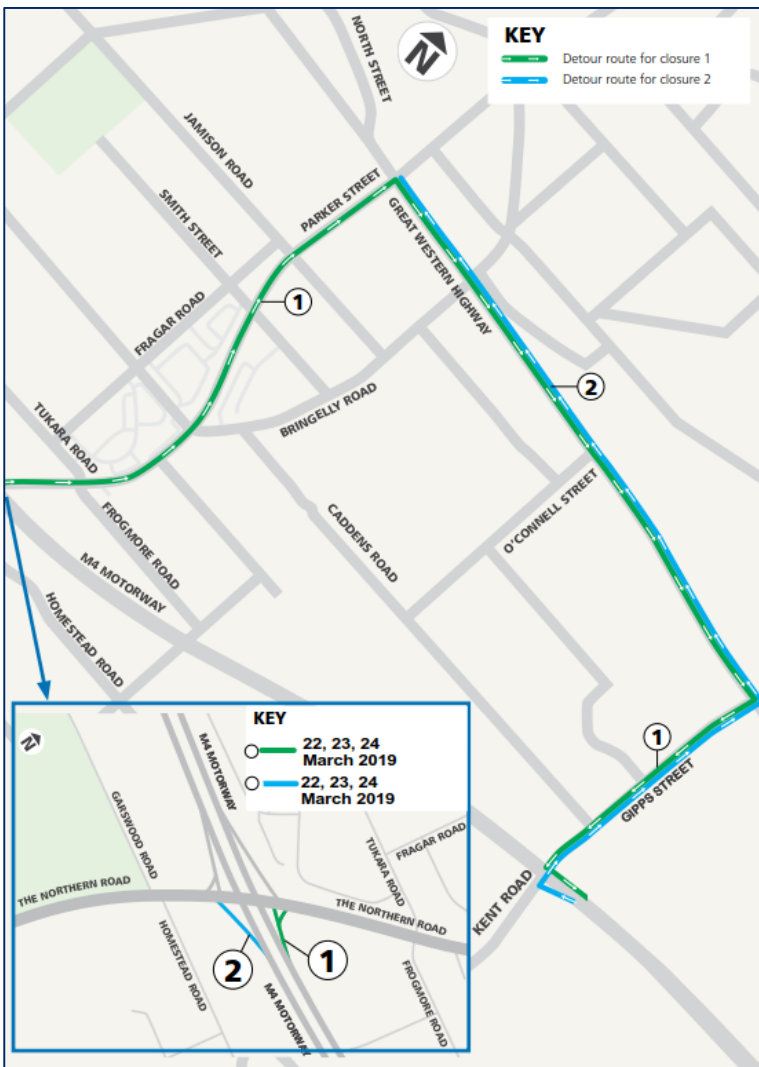

The east-facing M4 Motorway ramps at The Northern Road will be closed overnight, weather permitting, on:

- **Saturday 23 March from 10pm to 9am**
- **Sunday 24 March from 10pm to 5am**

West-facing M4 Motorway ramp closure

The west-facing M4 Motorway ramps at The Northern Road will be closed overnight, weather permitting, on:

- **Friday 29 March** from **10pm to 8am**
- **Saturday 30 March** from **10pm to 9am**
- **Sunday 31 March** from **10pm to 5am**

Work may also be required on these ramps on the following weekend. If further work is required, there will be closures of these ramps on:

- **Friday 5 April** from **10pm to 8am**
- **Saturday 6 April** from **10pm to 9am**
- **Sunday 7 April** from **10pm to 5am**

How will the work affect you?

Work in these locations will include:

- earthwork
- constructing drainage and road pavement
- asphaltting
- relocating street lights
- installing new traffic lights
- adjusting temporary barriers and signage
- line marking.

Our work may be noisy at times and will

involve cranes, saw cutting, loading and unloading trucks and hand tools. Every effort will be made to minimise impact on residents by:

- adapting our construction methods to reduce night work impacts as much as possible
- using equipment fitted with noise mitigation devices
- monitoring noise at night.

Traffic changes

Detours will be in place during the ramp closures which may affect travel times, please see maps for more information. Please keep to speed limits and follow the direction of detour signs and traffic controllers. For the latest traffic updates, you can call 132 701, visit livetraffic.com or download the Live Traffic NSW App.

Contact

If you have any questions or complaints, please contact our delivery partner Lendlease on 1800 870 665 or TNR.community@lendlease.com. For more information, visit rms.nsw.gov.au/thenorthernroad.

Thank you for your patience during this important work.

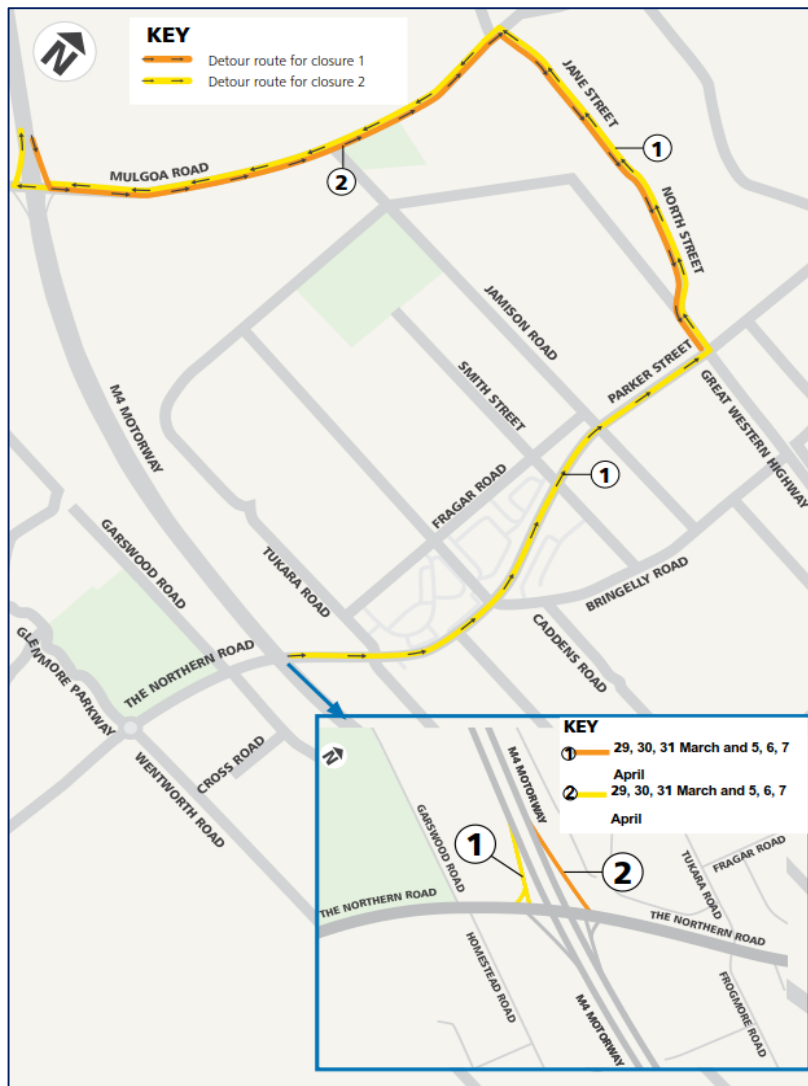

If you need help understanding this information, please contact the Translating and Interpreting Service on 131 450 and ask them to call us on 1800 870 665